



Redmayne Arnold & Harris
estate agents, letting agents & surveyors

rah.co.uk



TO LET



210 High Street, Chesterton, Cambridge, Cambridgeshire, CB4 1NX

£1,695 PCM

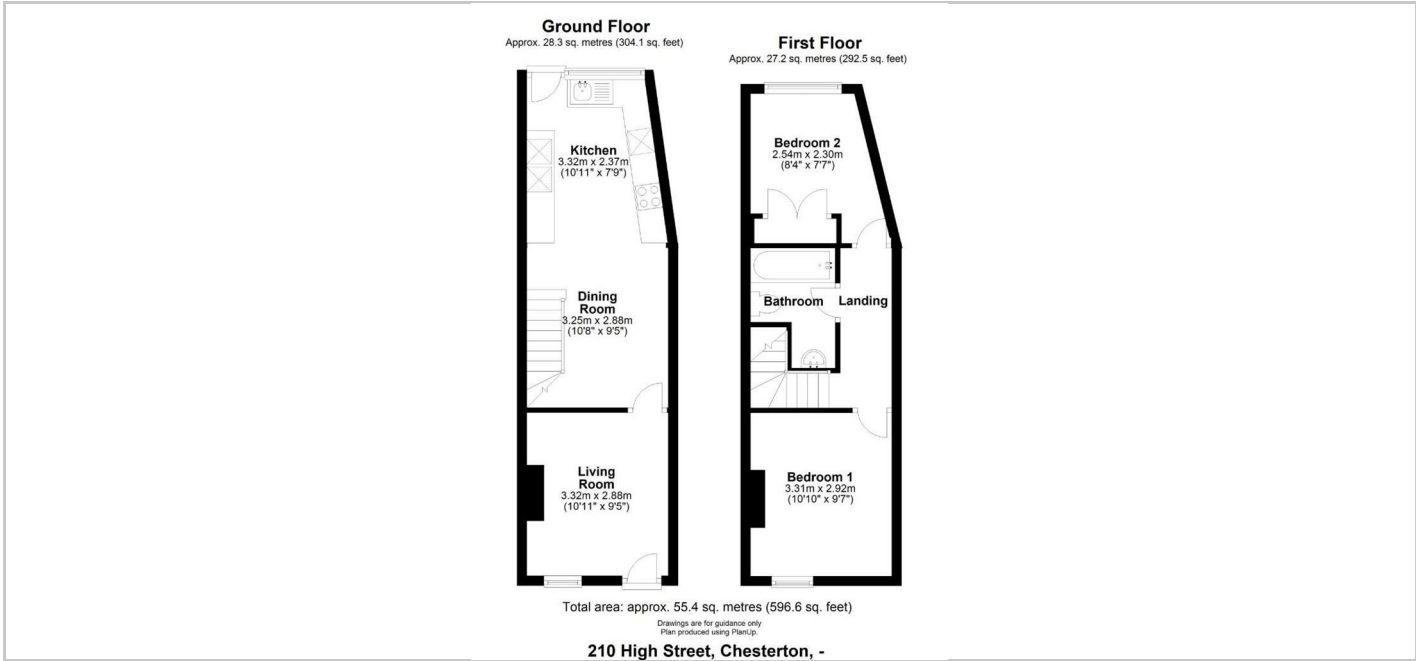

Directions

THE PROPERTY

A two bedroom mid-terraced house, located in Chesterton offering excellent access to the City Centre, A14 and Railway Station. The property comprises living room, open-plan kitchen/dining room, two bedrooms and a bathroom. There is an enclosed garden to the rear with side access, and on-street parking. The Property will be managed by RAH.

- EPC rating C
- Council Tax Band B
- Minimum 12 Month Tenancy
- Deposit £1950
- Holding Deposit: 390

SITUATION

